

We're working in your area

Transport projects in St Albans, Edgeware and Mairehau

ID: 20230
Friday 29 May 2020

What Road closure

Where Malvern Street, west of Cranford Street intersection

When From Tuesday 2 June 2020 for approximately three weeks

Contact Fulton Hogan on 0800 7623 34 (0800 ROAD FH) (Mon - Fri, 8am - 5pm) or email cant.info@fultonhogan.com. After business hours, please feel free to call us if the matter is urgent. Please advise us if you have specific property and access requirements e.g. vehicle deliveries, medical visits, planned work.

What are we doing?

From Tuesday 2 June 2020 for approximately three weeks, we will be closing Malvern Street at the west side of Cranford Street to carry out footpath and kerb and channel works here.

Traffic impacts

The road will be closed on Malvern Street west of Cranford Street. The east side of Malvern Street will be left out only as per the final design.

Please be on the lookout for changes to traffic management and follow the signs.

Driveway access

We may need to work in front of driveways near these intersections from time to time. If we are working in front of your driveway we will maintain your access with plates. We thank you for your patience.

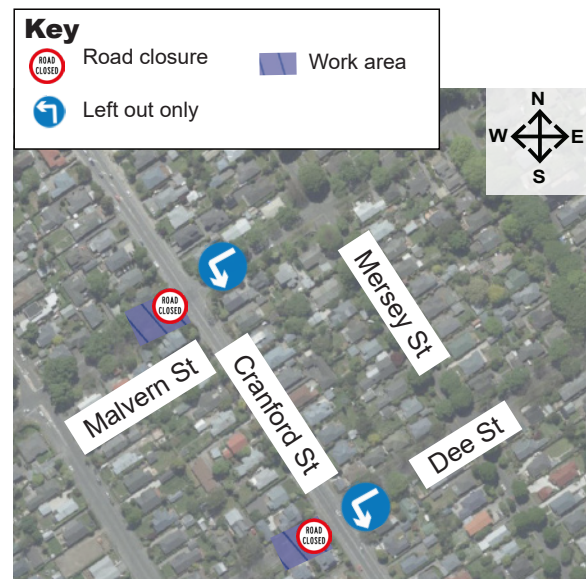

Thanks for your patience as we work in your area

Noise

There may be increased noise, dust and vibrations during work but it shouldn't impact on your power, water, gas or phone services.

Safety

Safety is our biggest priority so please keep children and pets away from worksites.

Bins

Please put your bins out as usual, before 6am on your collection day. Our crew will move and return them if needed.

Other projects

Learn about the Council's work.

ccc.govt.nz/works